

# DC35VP25RF (Quick-acting protector)

RoHS ~~Pb~~

DC35V



Scale: 2/1

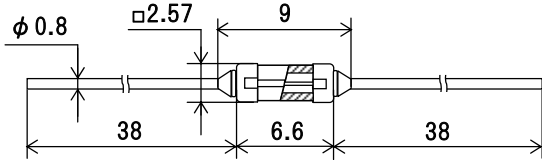

Unit: mm

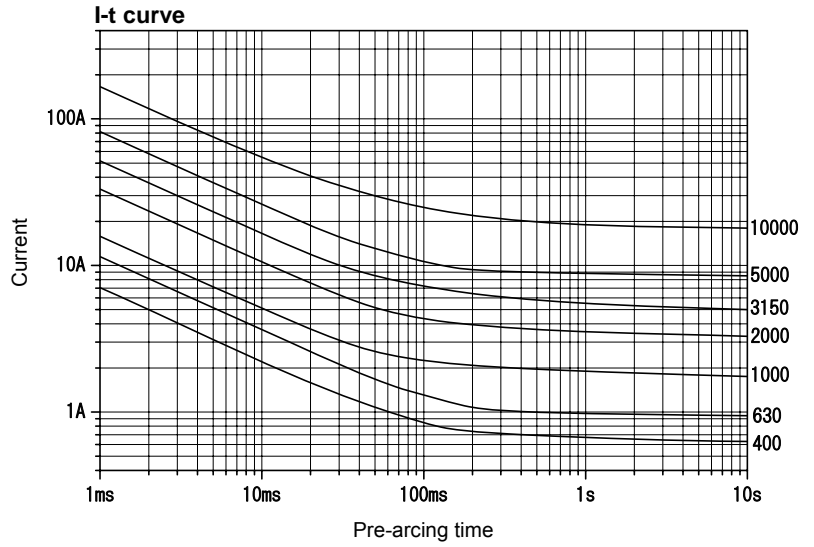

The I-t curves above are plots of the average values of measurements obtained under conditions specified by SOC. These data are for reference only and are not intended to infer any guaranteed values.

Maximum working voltage	Certification	Range of rated current ( $I_N$ ) *1	Maximum breaking current	Current carrying capacity	Temp. rise	Overload operation
DC35V	—	50mA - 10A	50A	Resistive circuit 1.0 $I_N$ until temperature stabilization occurs.	75K or less at 1.0 $I_N$	Within 60s at 2.0 $I_N$

\*1: Any rated current value can be selected within this range.

The numeric value "3150" shown on this product and its packaging expresses a rated current value obtained from multiplying 3.15 A by 1000.

# DC35VP25RT (Inrush-withstand protector)

RoHS ~~Pb~~

DC35V



Scale: 2/1

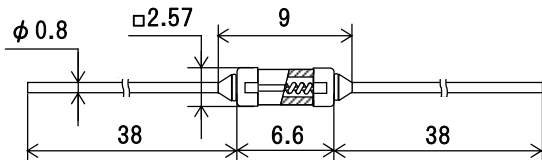

Unit: mm

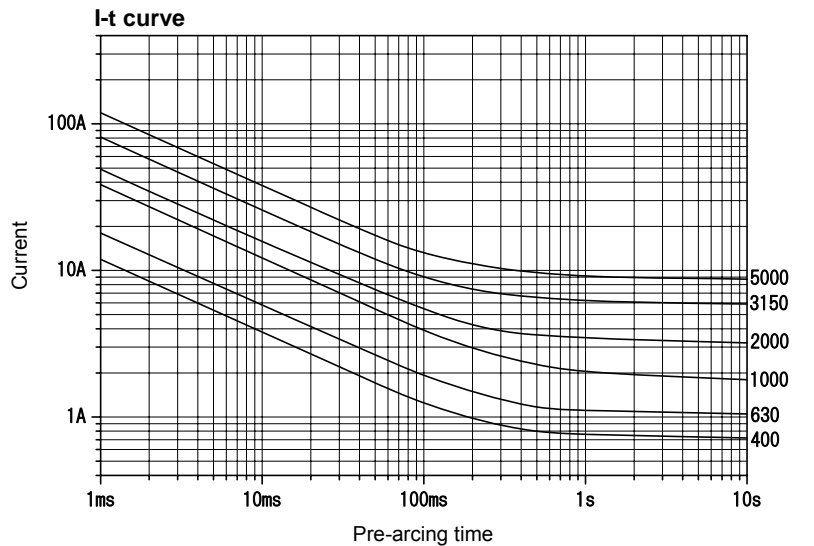

The I-t curves above are plots of the average values of measurements obtained under conditions specified by SOC. These data are for reference only and are not intended to infer any guaranteed values.

Maximum working voltage	Certification	Range of rated current ( $I_N$ ) *1	Maximum breaking current	Current carrying capacity	Temp. rise	Overload operation
DC35V	—	100mA - 6.3A	50A	Resistive circuit 1.0 $I_N$ until temperature stabilization occurs.	75K or less at 1.0 $I_N$	Within 60s at 2.0 $I_N$

\*1: Any rated current value can be selected within this range.

The numeric value "3150" shown on this product and its packaging expresses a rated current value obtained from multiplying 3.15 A by 1000.